



Marroney Theatre

Little Women

Amy March Unit

LINE STYLE KEY		
Wood:	<div></div>	1/4" Facing:
Steel:	<div></div>	3/4" Facing:
Foam:	<div></div>	Hidden Line:
Director:	Brent Gibbs	Date: 2/10/2025
Technical Director(s): Daniel Staggs		
Drafted By: Riley Baheshone		
Scale: As Noted	Scenic Designer: Joe Klug	

Notes:

- Bookshelf is made of 2" Foam
- Measure twice, cut once

1 of 6

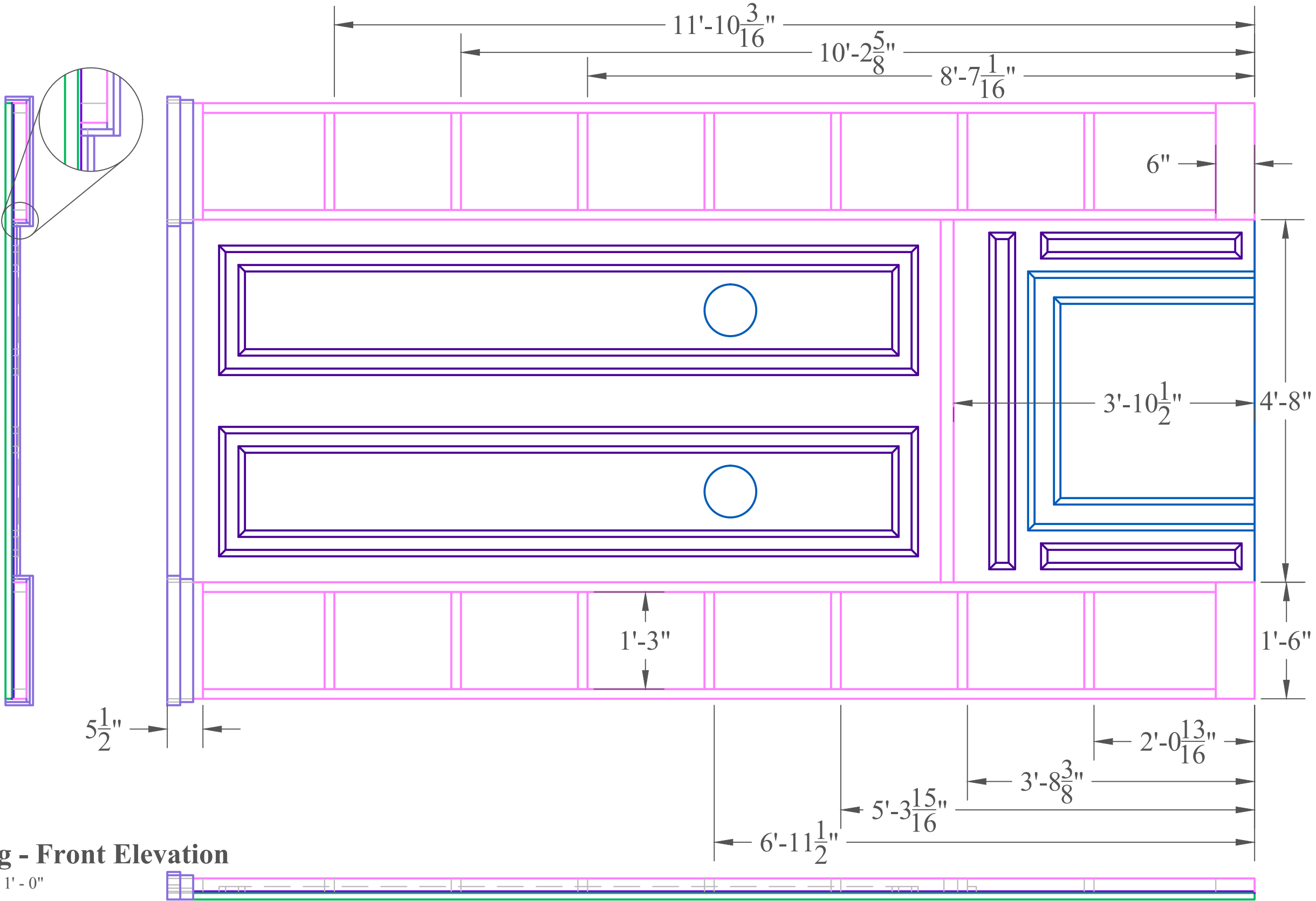

Facing - Front Elevation

Scale: $\frac{3}{4}$ " = 1' - 0"

Turn your Paper :)



Marroney Theatre

Little Women

Amy March Unit

LINE STYLE KEY			
Wood:	<div></div>	1/4" Facing:	<div></div>
Steel:	<div></div>	3/4" Facing:	<div></div>
Foam:	<div></div>	Hidden Line:	<div></div>
Director:	Brent Gibbs		Date: 2/10/2025
Technical Director(s): Daniel Staggs			
Drafted By: Riley Baheshone			
Scale: As Noted		Scenic Designer: Joe Klug	

Notes:

- Foam should be flush with the edges.
- Wait on Fireplace Details until Fireplace is attached.
- Foam should be attached before the Crown Moulding is attached.

2 of 6

A guide for which trim should be capping.

Moulding should be flush to the top.

Facing - Placements

Scale: $\frac{3}{4}$ " = 1' - 0"

Turn your Paper :)



Marroney Theatre

Little Women

Amy March Unit

LINE STYLE KEY			
Wood:		1/4" Facing:	
Steel:		3/4" Facing:	
Foam:		Hidden Line:	
Director:	Brent Gibbs	Date:	2/10/2025
Technical Director(s): Daniel Staggs			
Drafted By: Riley Baheshone			
Scale: As Noted		Scenic Designer:	Joe Klug

Notes:

- Crown moulding should be made of $\frac{1}{2}$ " material.
- Panel Moulding should be made of $\frac{3}{4}$ " material.
- Measure twice, cut once.
- Ask Riley if you have any questions!

3 of 6

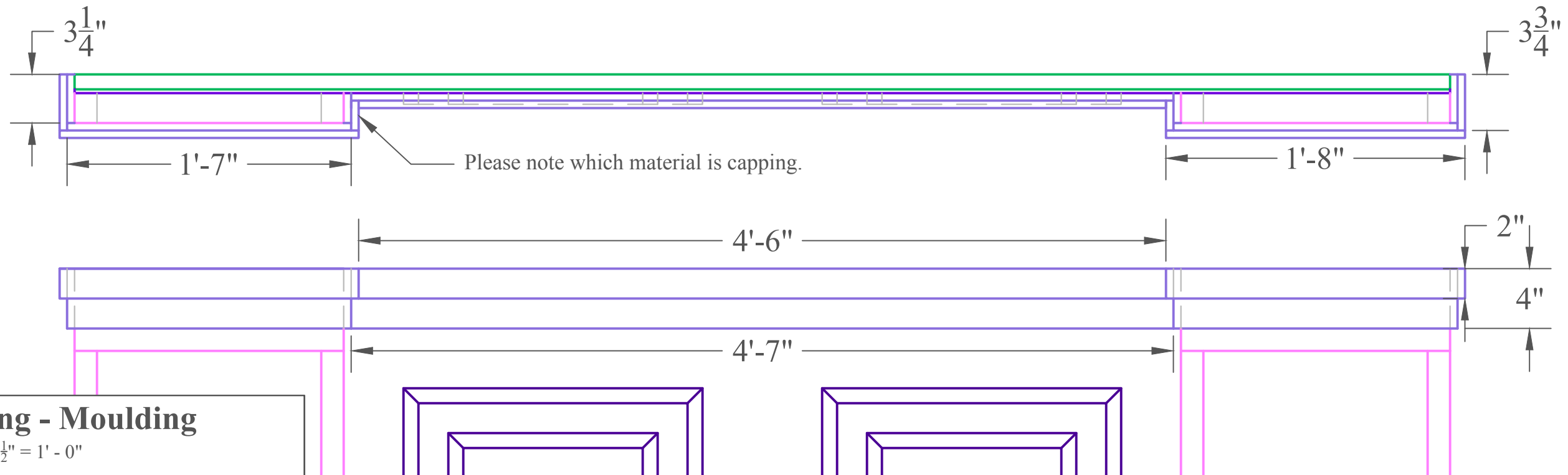

Facing - Moulding

Scale: 1 $\frac{1}{2}$ " = 1' - 0"

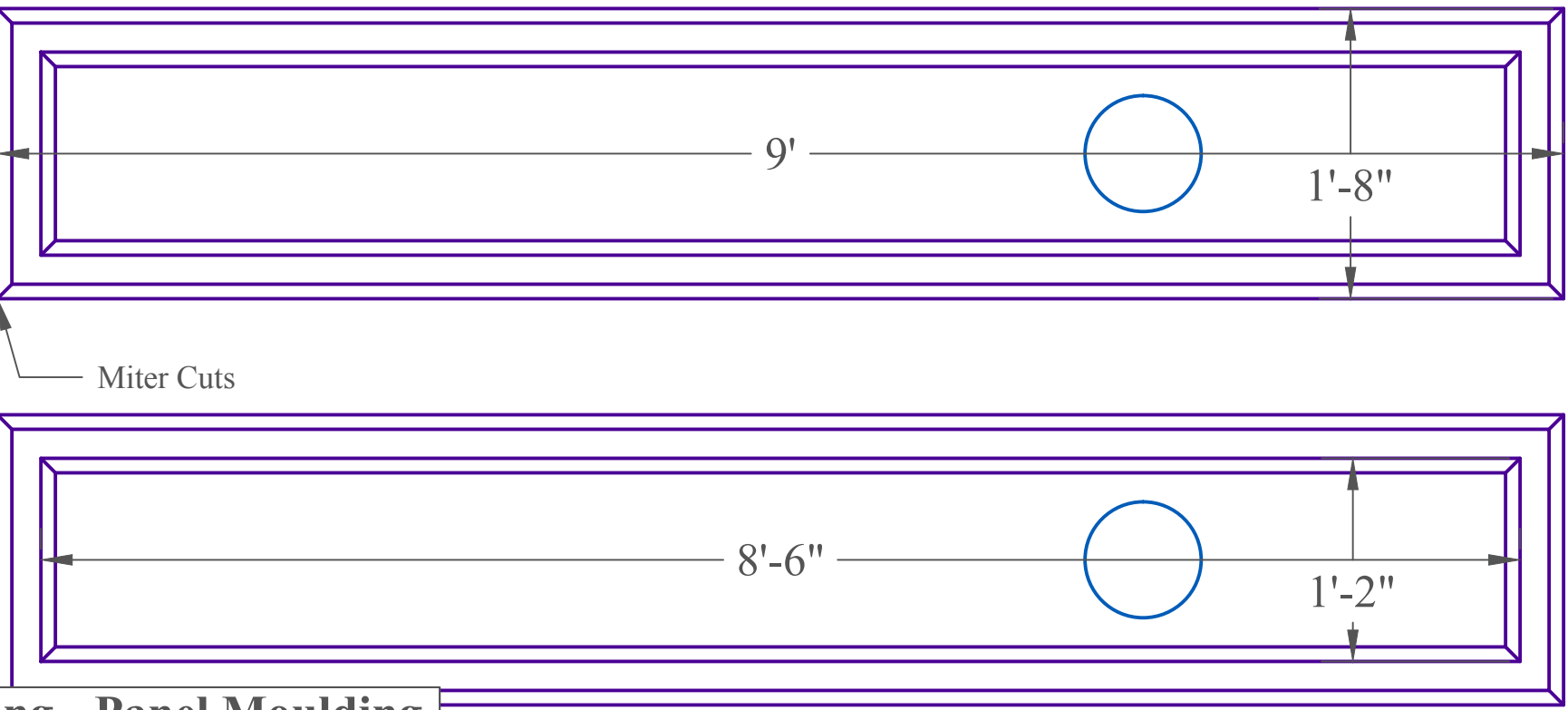

Facing - Panel Moulding

Scale: 1" = 1' - 0"

Facing - Moulding *close up*









Scale: 1 $\frac{1}{2}$ " = 1' - 0"



Marroney Theatre

Little Women

Amy March Unit

LINE STYLE KEY				
Wood:			1/4" Facing:	
Steel:			3/4" Facing:	
Foam:			Hidden Line:	
Director: Brent Gibbs		Date: 2/10/2025		
Technical Director(s): Daniel Staggs				
Drafted By: Riley Baheshone				
Scale: As Noted		Scenic Designer: Joe Klug		

Notes:

- Steel is 1x box tube and 1x2 box tube
- Measure twice, cut once
- 1x2 is used as seam catches for luan facing

4 of 6

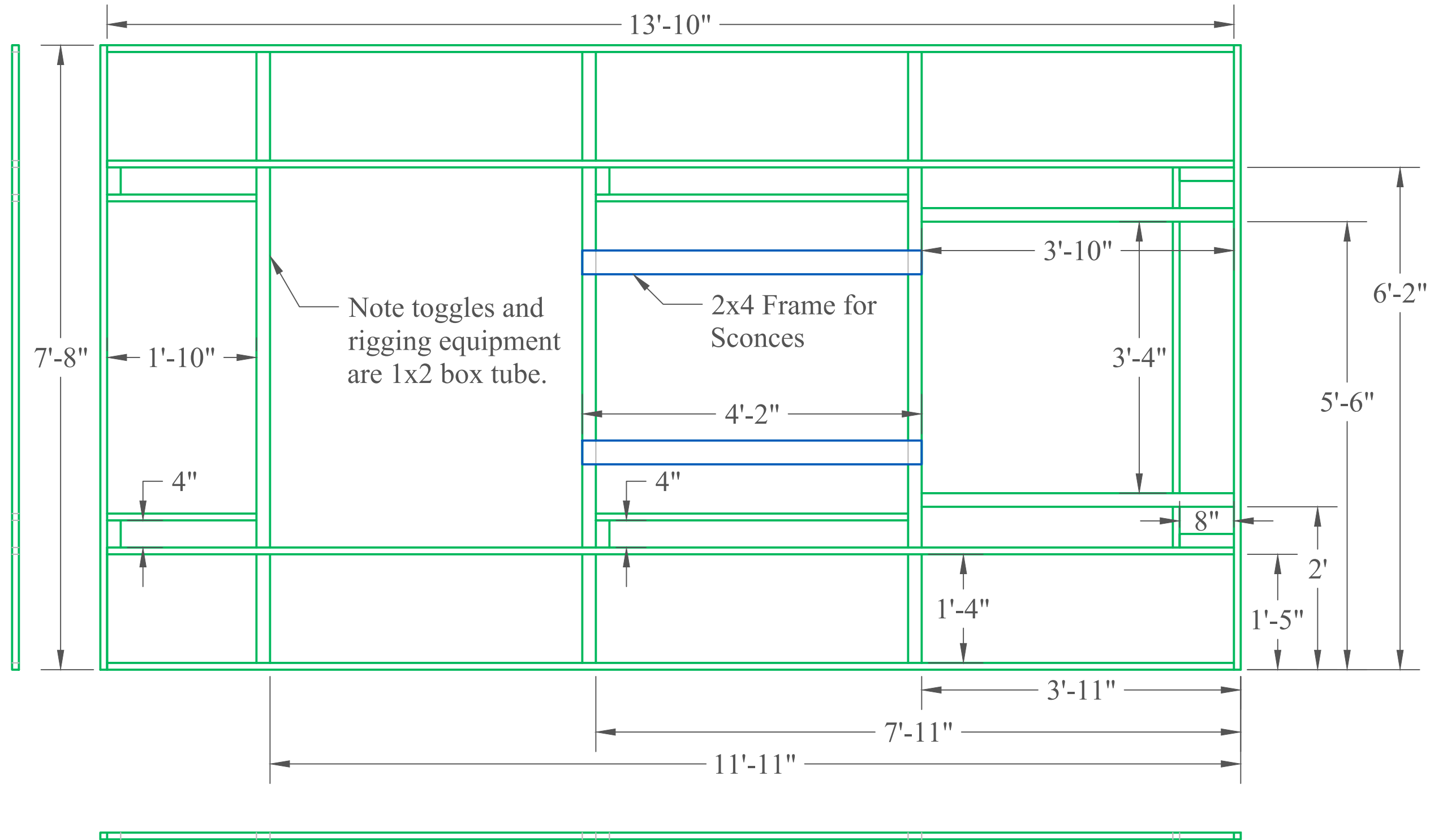

Steel Layout - Rear View

Scale: $\frac{3}{4}$ " = 1' - 0"

Turn your Paper :)

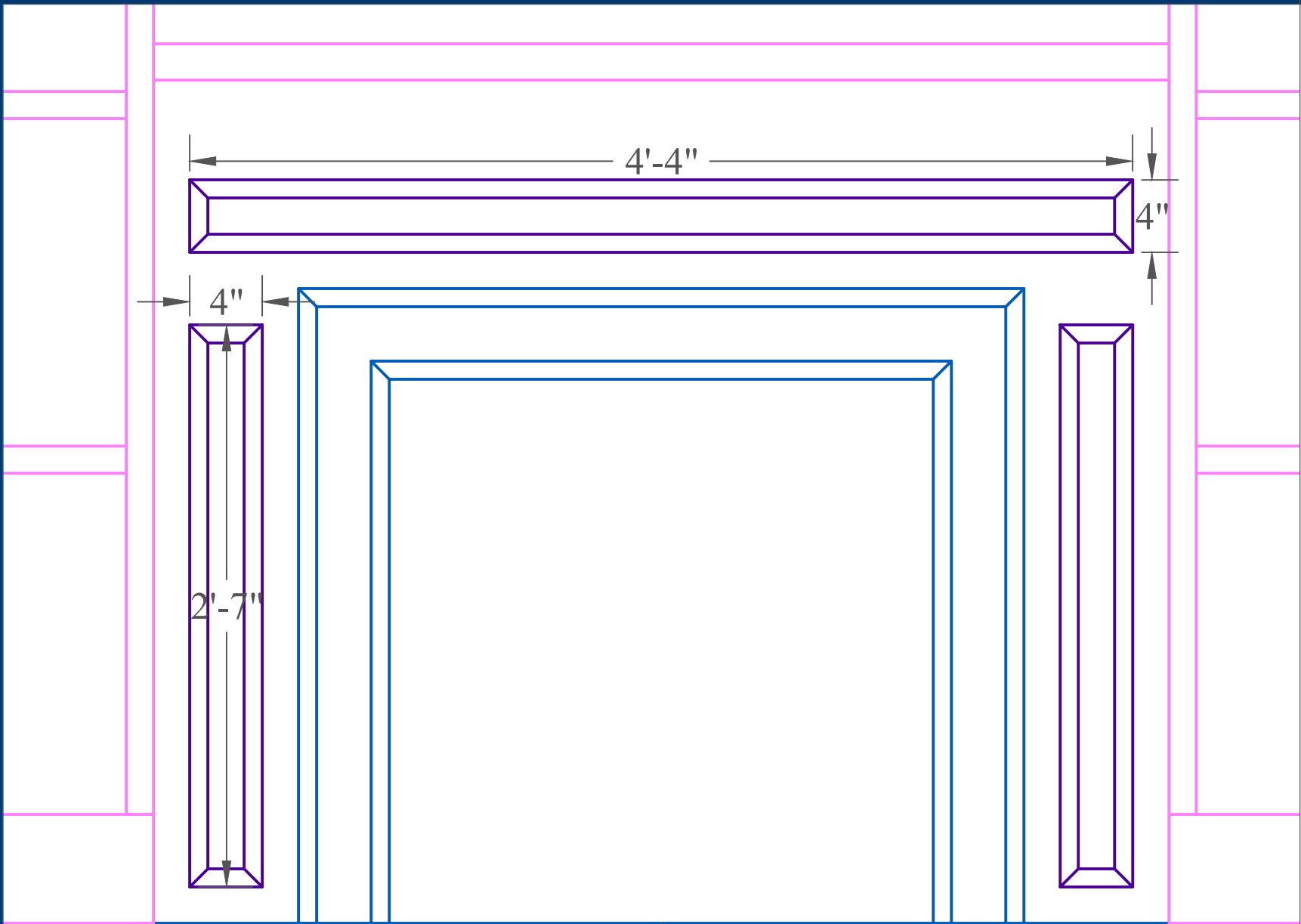

Wait to attach until stock fireplace is in place.

Facing - Fireplace Panel Moulding
Scale: 1 ½" = 1' - 0"

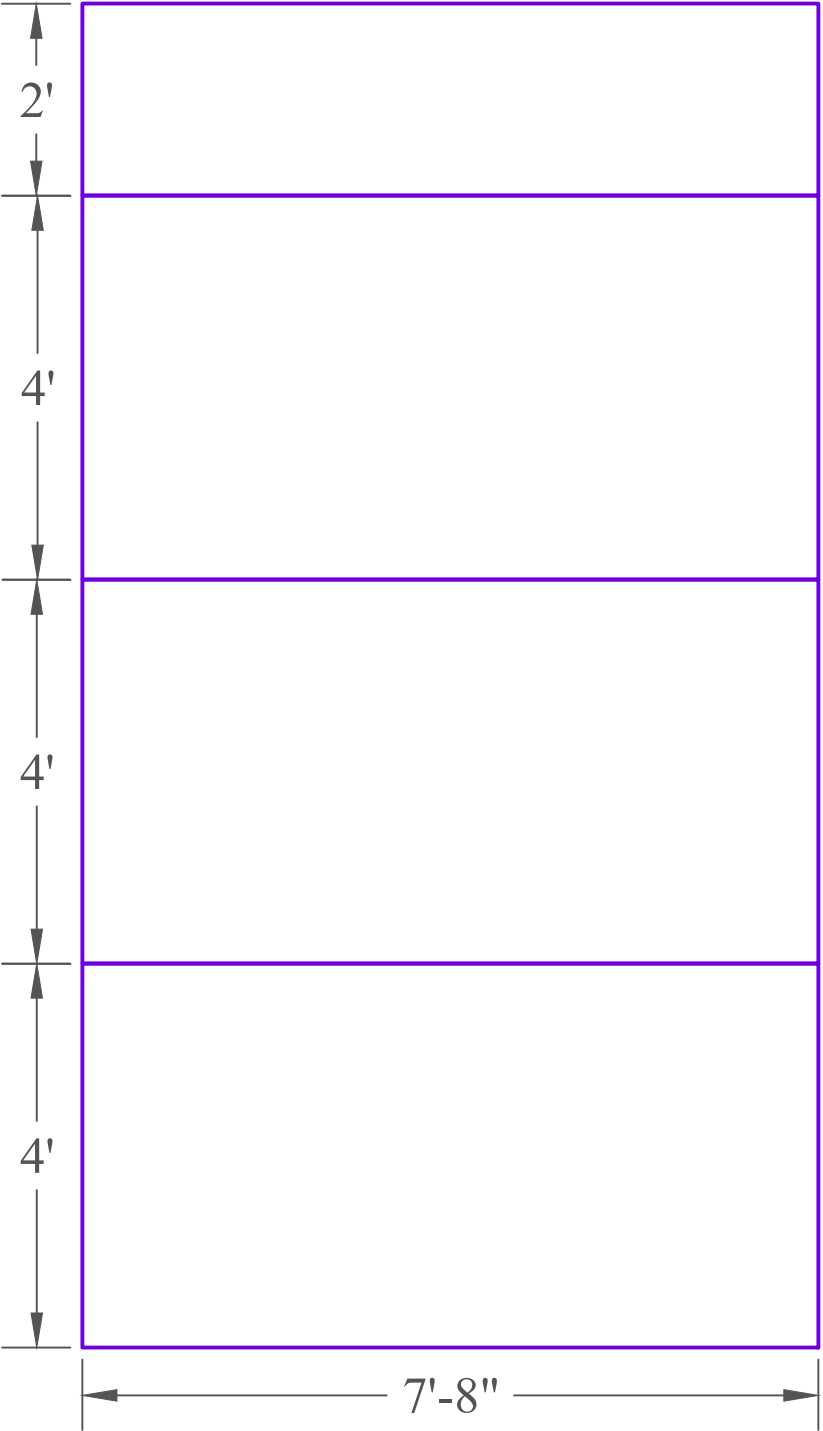

Luan Layout - Front View
Scale: ½" = 1' - 0"



Marroney Theatre

Little Women

Amy March Unit

LINE STYLE KEY			
Wood:		1/4" Facing:	
Steel:		3/4" Facing:	
Foam:		Hidden Line:	
Director: Brent Gibbs		Date: 2/10/2025	
Technical Director(s): Daniel Staggs			
Drafted By: Riley Baheshone			
Scale: As Noted		Scenic Designer: Joe Klug	

Notes:

- Facing should be ¼" Luan.
- Hold off on panel moulding for fireplace until stock fireplace is attached.

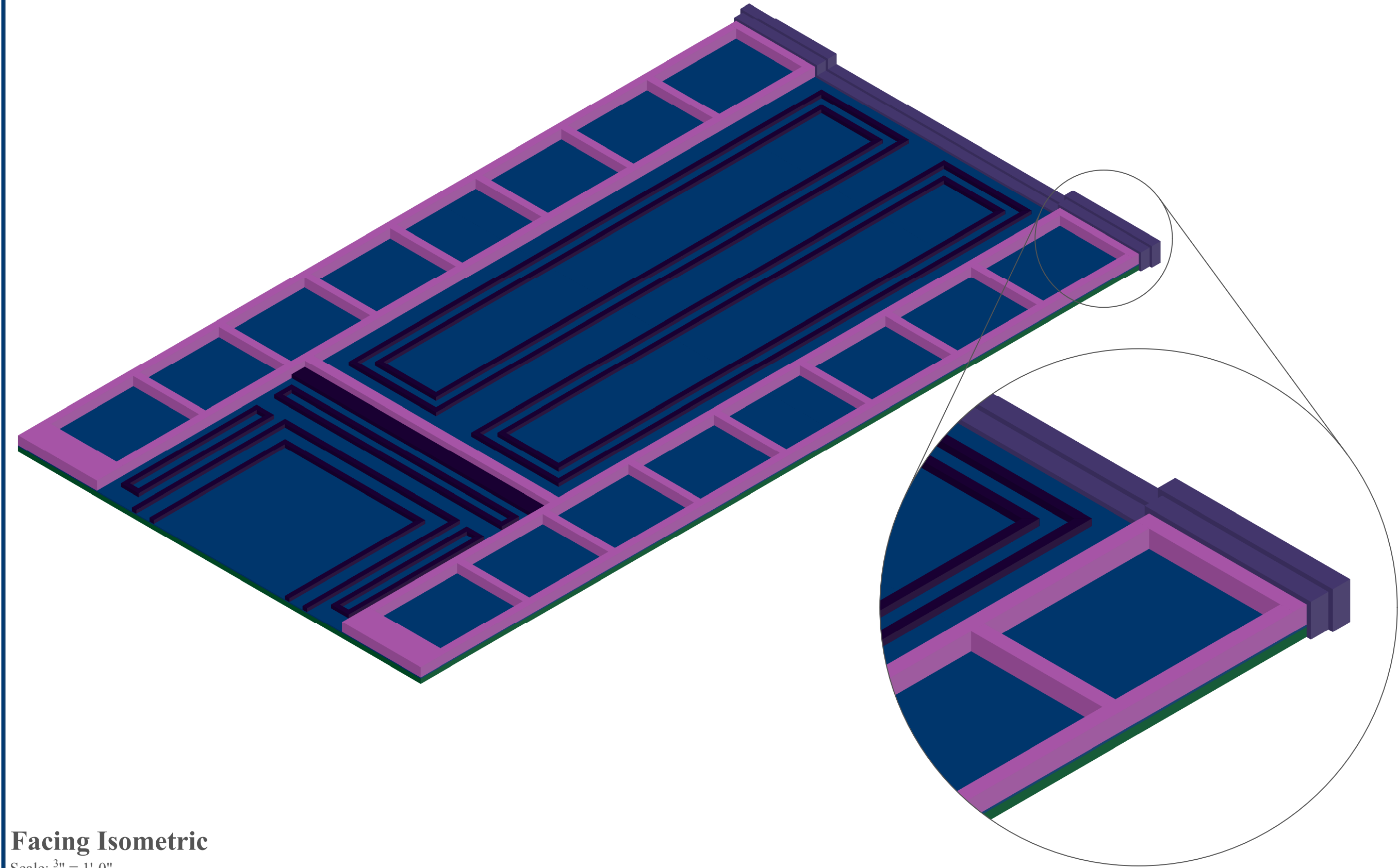

Facing Isometric
Scale: $\frac{3}{4}$ " = 1'-0"



Marroney Theatre

Little Women

Amy March Unit

LINE STYLE KEY			
Wood:	1/4" Facing:		
Steel:	3/4" Facing:		
Foam:	Hidden Line:		
Director:	Brent Gibbs	Date:	2/17/2025
Technical Director(s):	Daniel Staggs		
Drafted By:	Riley Baheshone		
Scale:	As Noted	Scenic Designer:	Joe Klug

Notes:
Add notes here.